



TULSA RACE MASSACRE INVESTIGATION 2020-21

2021 FORENSIC FINDINGS

PHOEBE R. STUBBLEFIELD AND KARY L. STACKELBECK

OAKLAWN CEMETERY EXPECTATIONS

There were 13 other negroes, eight of whom were identified, buried in potter's field of Oaklawn cemetery yesterday. Those who were identified were: Curly Walker, Henry Walker, Ed Adams, Joe Muller, George Lewis, Sam Ree and Ed Howard. The 13 blacks were buried separately and in plain caskets. Some trouble was experienced in getting graves dug, but finally several blacks volunteered for the work.

Name	Race	Age	Birth Place	Cause of Death	Place of Burial	Death Certificate Number
Adams, Ed	Black	32		GSW	Tulsa (Oaklawn)	450
Alexander, Greg	Black	35		GSW	Tulsa (Oaklawn)	455
Barrens, Howard	Black	19	TX	GSW	Gatesville, TX	488
Everett, Reuben E.	Black			GSW	Tulsa (Oaklawn)	469
Howard, Ed	Black			GSW	Tulsa (Oaklawn)	444
Jackson, Andrew C.	Black	40	(TN)	GSW	Guthrie, OK	462
Jeffrey, George	Black	36		GSW	Tulsa (Oaklawn)	468
Johnson, H.	Black			GSW	Muskogee, OK	494
Knox, Commodore	Black	21	MS	GSW	Tarrance MS	657
Lewis, ?	Black			GSW	Tulsa (Oaklawn)	443
Lockard, Ed	Black			GSW	Tulsa (Oaklawn)	476
Miller, Joe	Black	35		GSW	Tulsa (Oaklawn)	449
Ree, Sam	Black	30		GSW	Tulsa (Oaklawn)	457
Turner, William	Black			GSW	Tulsa (Oaklawn)	477
Unidentified	Black			GSW	Tulsa (Oaklawn)	470
Unidentified	Black			Unknown	Tulsa (Oaklawn)	471
Unidentified	Black			Burns	Tulsa (Oaklawn)	463
Unidentified	Black			Burns	Tulsa (Oaklawn)	453
Unidentified	Black			Burns	Tulsa (Oaklawn)	454
Unidentified	Black			GSW	Tulsa (Oaklawn)	458
Unidentified	Black			Burns	Tulsa (Oaklawn)	456
Unidentified	Black	28		GSW	Tulsa (Oaklawn)	459
Unidentified	Black	Infant			Tulsa (Oaklawn)	445
Walker, Curley	Black	30		GSW	Tulsa (Oaklawn)	452
Walker, Henry	Black	40		GSW	Tulsa (Oaklawn)	451
Wheeler, John	Black	63		GSW	Ft. Smith, AR	461

OAK LAWN CEMETERY

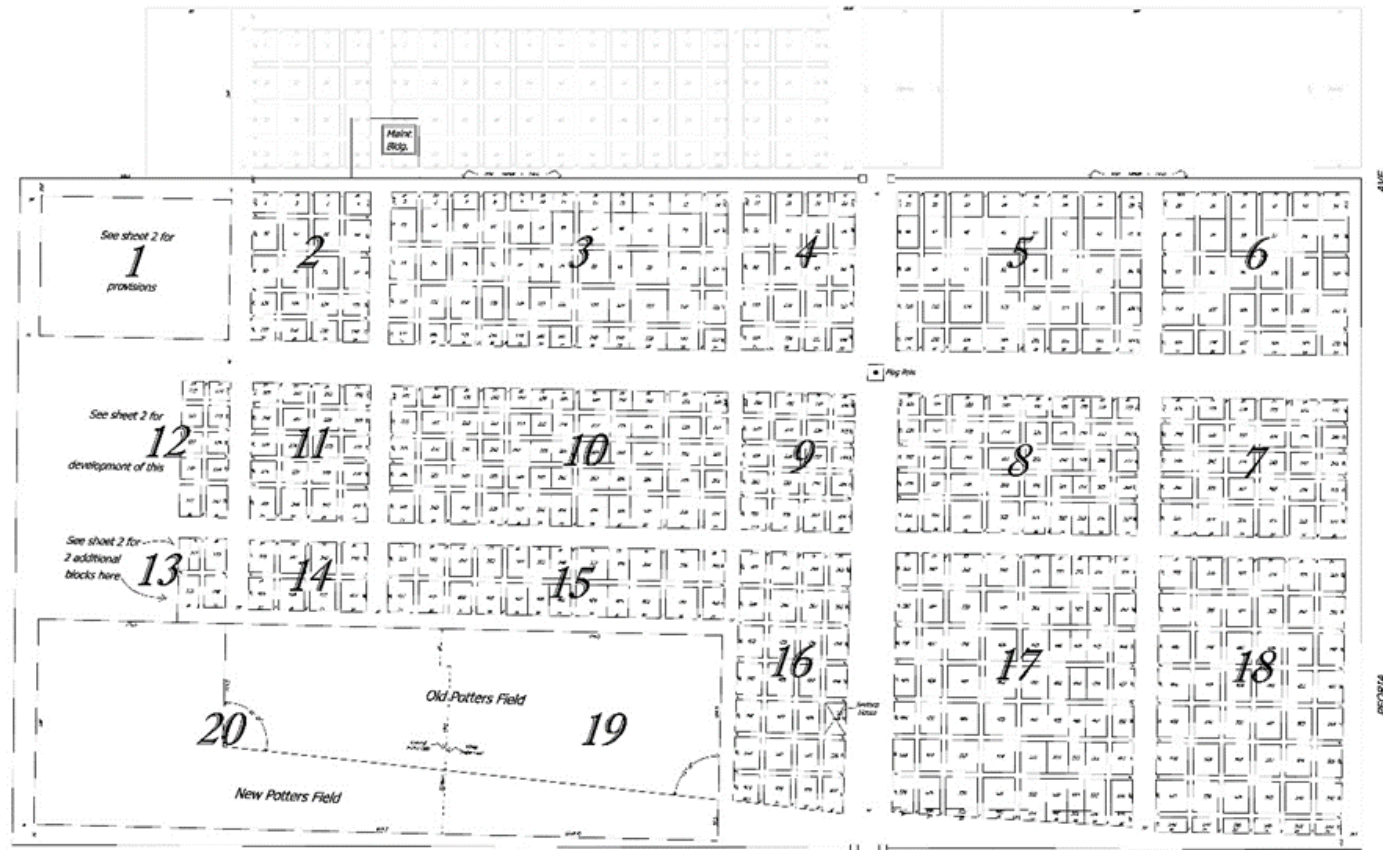

See sheet 2 for
1
provisions

See sheet 2 for
development of this
12

See sheet 2 for
2 additional
blocks here **13**

Note: Sections numbered
and corrections made in 1935
Sheet 1 of 3 sheets.

John W. Curtis and wife, Petors
vs. W. H. Curtis, et al. 10000
by the Petors.

I hereby certify that I have made a true and
accurate survey of blocks 4 and 5 of the Oak Lawn
Addition to Tulsa for an Addition to Oak Lawn Cemetery
and the above plat is true of same. March 26th to April 3rd 1917
C. W. McKinstry, Chief Engineer
L.S. 10

Table 2. Select Biological Profile Data for the Female Oaklawn Unknown Individuals with Plain Coffin Status

Burial Number	Individualizing Traits	Health Conditions	Trauma Associated w/ Cause of Death	Plain Coffin (Yes or No)
1	None observed	None observed	None observed	No
4	fetal remains in pelvis	Near term pregnancy	None observed	No
13	None	Linear enamel hypoplasia dental defects	None observed	No
14	None	None observed	None observed	No
16	None	None observed	None observed	No
28	dental bridge with gold features	None observed	None observed	No

Table 3. Select Biological Profile Data for the Male Oaklawn Unknown Individuals with Plain Coffin Status

Burial Number	Individualizing Traits	Health Conditions	Trauma Associated w/ Cause of Death	Plain Coffin (Yes or No)
3	Gold teeth #9 and #10	Linear enamel hypoplasia dental defects	None observed	Yes
9	None	None observed	None observed	Yes
15	Femoral bowing	Linear enamel hypoplasia dental defects	None observed	Yes
17	None	Linear enamel hypoplasia dental defects	None observed	Yes
19	Probable antemortem GSW to left jaw	Probable antemortem GSW to left jaw	None observed	Yes
27	None	None observed	Multiple gunshot wounds	Yes
29	LEH	None	None observed	No
30	None	possible metastatic disease	None observed	Yes

Table 5. Male Oaklawn Unknown Individuals Assessed for Characteristics of the Original 18 Burials

Burial Number	Plain Coffin	Evidence of Projectile Trauma or Burning	Status as Possible Original 18 Burial
3	Yes	None observed	Not Excluded
9	Yes	None observed	Not Excluded
15	Yes	None observed	Not Excluded
17	Yes	None observed	Not Excluded
19	Yes	None observed	Not Excluded
27	Yes	Multiple gunshot wounds	Included
29	No	None observed	Excluded
30*	Plain	None observed	Not Excluded*

* Burial 30 had a metastatic disease or similar ailment at the time of death. He is not excluded, as riot activity could be a contributing factor to the death.

Table 6. Oaklawn Unknown Individual(s) Suitable for Consideration as a Possible Tulsa Race Massacre Victim

Burial Number	Plain Coffin	Evidence of Projectile Trauma or Burning
27	Yes	Multiple gunshot wounds





KEY FINDINGS: ARCHAEOLOGICAL

Burials of archaeological interest

Substantial alterations of landscape in Oaklawn Cemetery, especially New Potter's Field

Snow Model

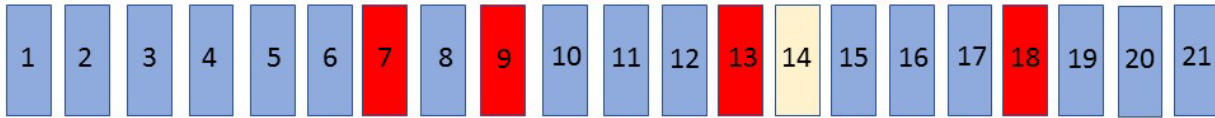

- | | | | |
|----------------------|---|--|--|
| 1. Greg Alexander | 12. UGSW | | |
| 2. Henry Walker | 13. UBV | | |
| 3. Ed Adams | 14. Stillborn infant | | |
| 4. Joe Miller | 15. * | | |
| 5. UGSW | 16. * | | |
| 6. Sam Ree | 17. * | | |
| 7. UBV | 18. UBV | | |
| 8. ? Lewis | 19. Eddie Lockard | | |
| 9. UBV | 20. * | | |
| 10. Curly Walker | 21. * | | |
| 11. Edward G. Howard | * Reuben Everett, George Jeffrey, William Turner, or UGSW | | |





Mass Grave Model



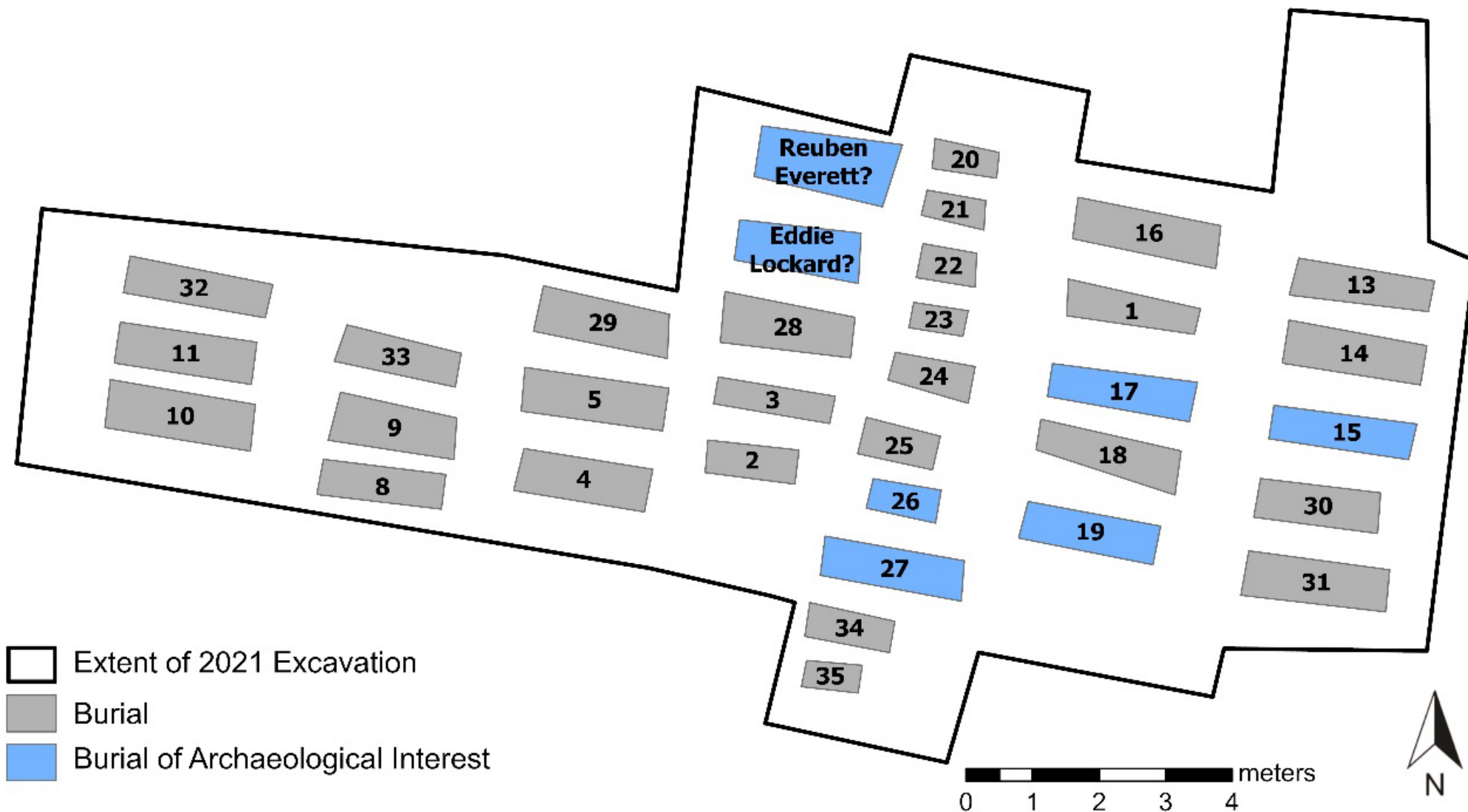

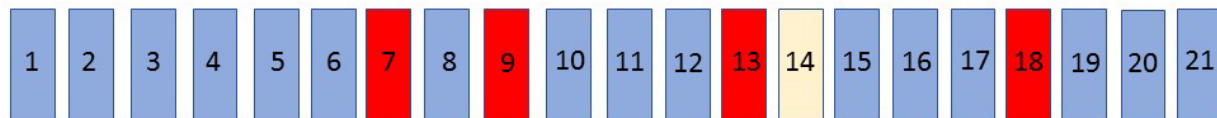
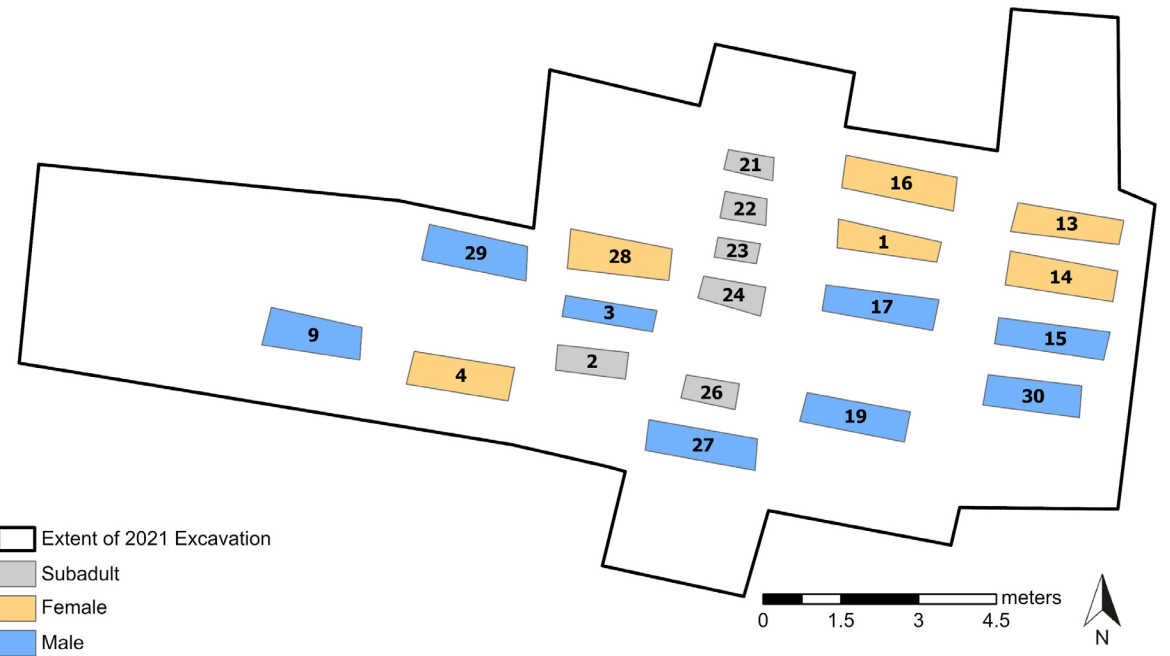
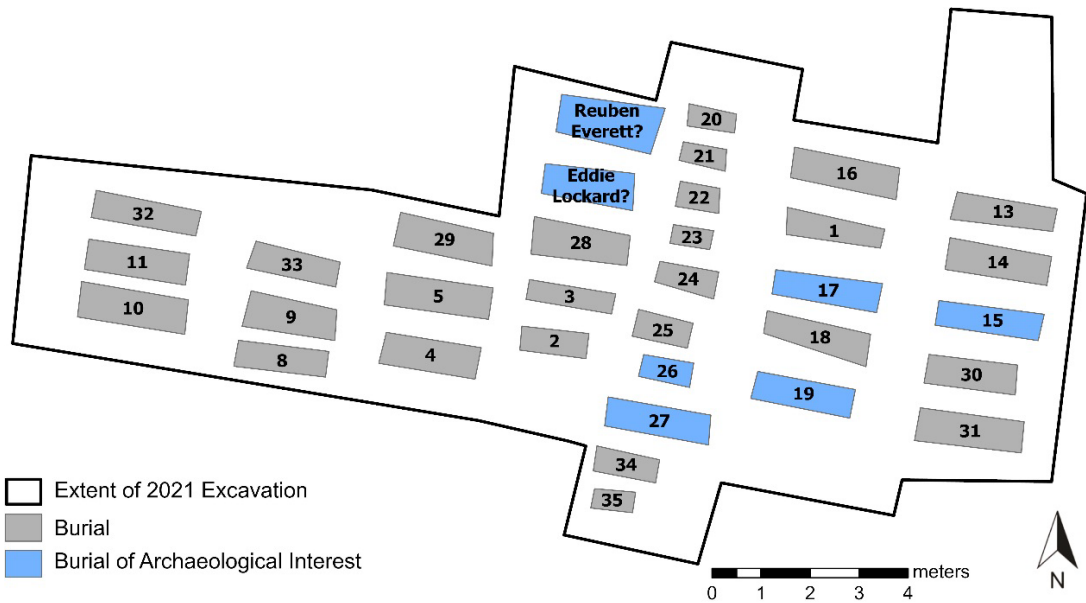



- | | | |
|----------------------|---|---|
| 1. Greg Alexander | 12. UGSW |  Gunshot wound

 Burn victim |
| 2. Henry Walker | 13. UBV | |
| 3. Ed Adams | 14. Stillborn infant | |
| 4. Joe Miller | 15. * | |
| 5. UGSW | 16. * | |
| 6. Sam Ree | 17. * | |
| 7. UBV | 18. UBV | |
| 8. ? Lewis | 19. Eddie Lockard | |
| 9. UBV | 20. * | |
| 10. Curly Walker | 21. * | |
| 11. Edward G. Howard | * Reuben Everett, George Jeffrey, William Turner, or UGSW | |



FIGURE 6. SCATTERPLOT OF BURIALS IN SECTION 19 FOR 1921, FROM CITY OF TULSA LEDGER. ROW NUMBERS ARE THE Y-AXIS, GRAVE NUMBER THE X-AXIS. FIVE BURIALS WERE RECORDED, FOR AUGUST AND OCTOBER.

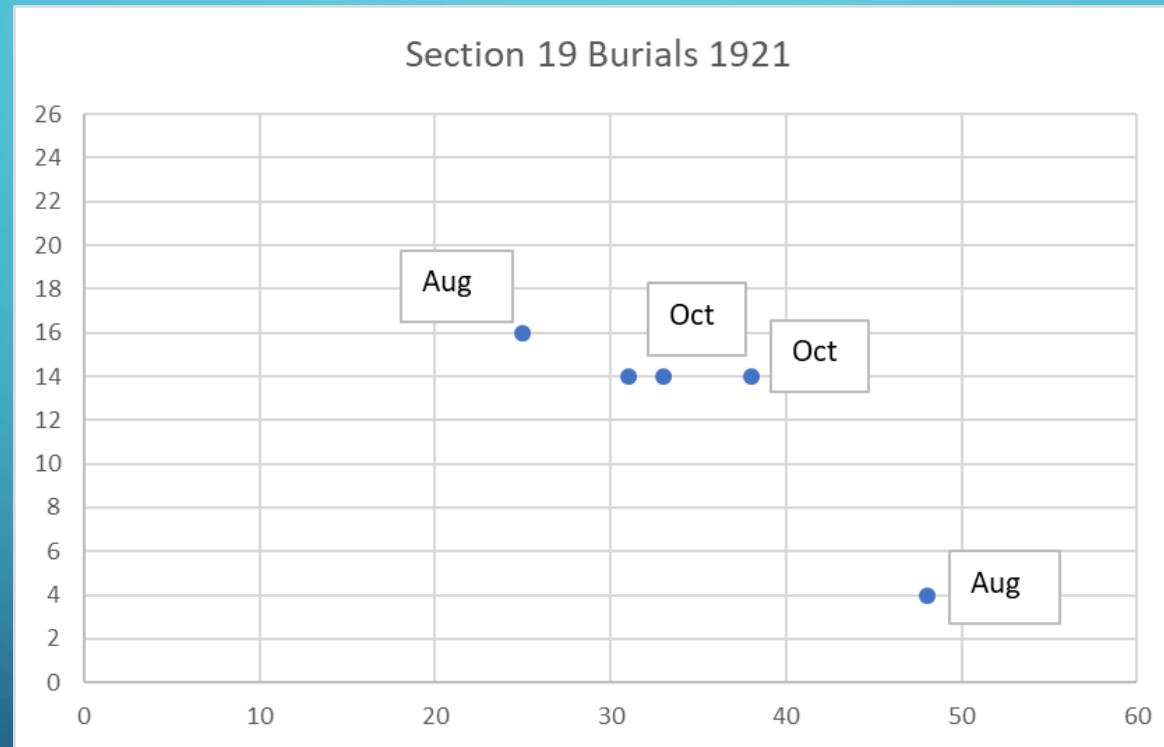
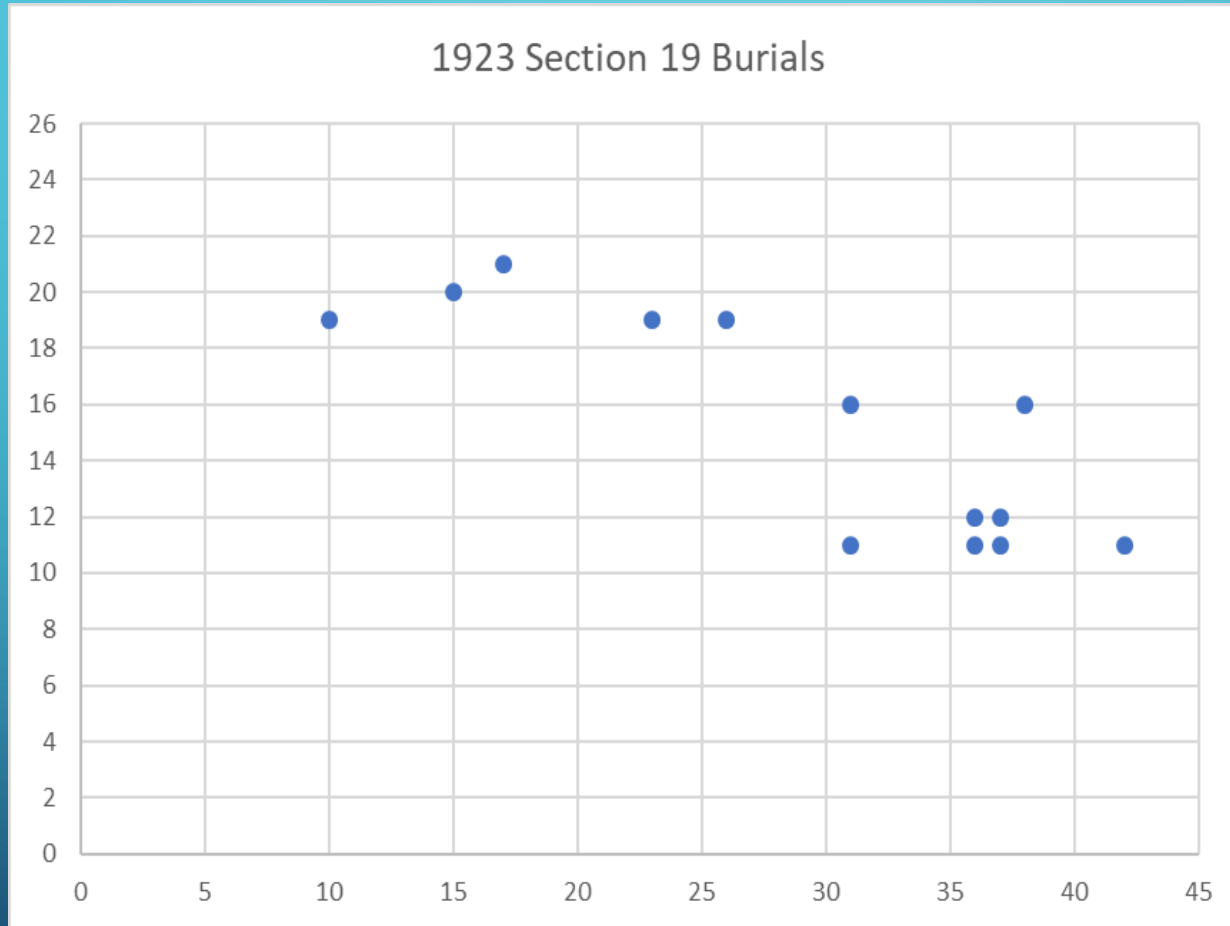

FIGURE 7. BURIALS IN THE PEAK RECORDING YEAR, THIRTEEN BURIALS IN 1923.



Row numbers are the Y-axis, grave number the X-axis. Row 11 was used four times, in January, February, March, and July.

RECOMMENDATIONS

Systematic enlargement of excavation area in Section 20 focusing on exhuming simple coffin black male burials

Conduct geoarchaeological survey of Newblock Park/Canes areas

Encourage community engagement for family reference DNA samples